



ASKING PRICE

£199,950

THE DETAILS



59a Derby Road
Douglas
£199,950

call in today or visit www.blackgracecowley.com for more details

e: hello@blackgracecowley.com | w: blackgracecowley.com | t: +44 (0) 1624 645555

a: 51 Victoria Street, DOUGLAS, Isle of Man, IM1 2LD

PROPERTY DETAILS FOR
59a Derby Road, Douglas



PROPERTY DETAILS FOR
59a Derby Road, Douglas



PROPERTY DETAILS FOR
59a Derby Road, Douglas





PROPERTY DETAILS FOR

59a Derby Road, Douglas

THE DESCRIPTION

- Mid terraced house situated in a central and convenient location
- Situated at the rear of Derby Road
- Ideal for First Time Buyers or Investment
- Entrance Hall, open plan Kitchen/Living Area, spacious fitted Kitchen
- 2 Bedrooms and newly fitted Bathroom
- Gas fired central heating and uPVC double glazing
- No onward chain

THE PROPERTY

Black Grace Cowley are delighted offer this mid terraced property located within walking distance of Douglas town centre. Situated at the rear of Derby Road this 2 Bedroom property is ideal for First Time Buyers or Investors. Upon entering the property the Hall with stairs to the upper floor and access to the open plan Lounge/Kitchen Diner. The Lounge/Dining Area is fitted with wood effect flooring and access to an under stairs storage cupboard. The Kitchen is fitted with wood effect wall, base and drawer units and laminate work top, electric oven, 5 ring gas hob with extractor over, integrated washer dryer, fridge freezer, space for dishwasher and tiled flooring.

On the first floor is a single Bedroom with dual aspect uPVC windows. Recently refitted 3 piece Bathroom suite comprising panelled bath with shower over, vanity wash hand basin and WC with tiled flooring, mermaid board fitted to the bath, shower and sink area, ladder towel rail and infinity mirror. Double Bedroom fitted with 2 uPVC windows.

Gas fired central heating and uPVC double glazing. No onward chain.

FLOORPLAN

GROUND FLOOR
249 sq.ft. (23.1 sq.m.) approx.

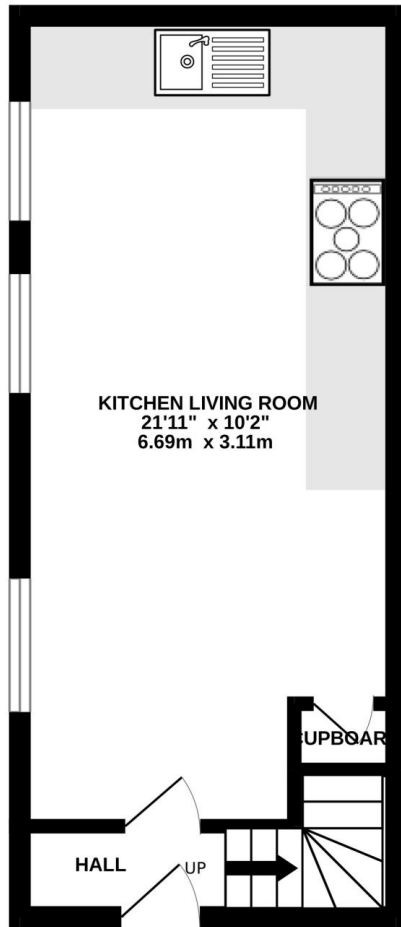

1ST FLOOR
249 sq.ft. (23.1 sq.m.) approx.

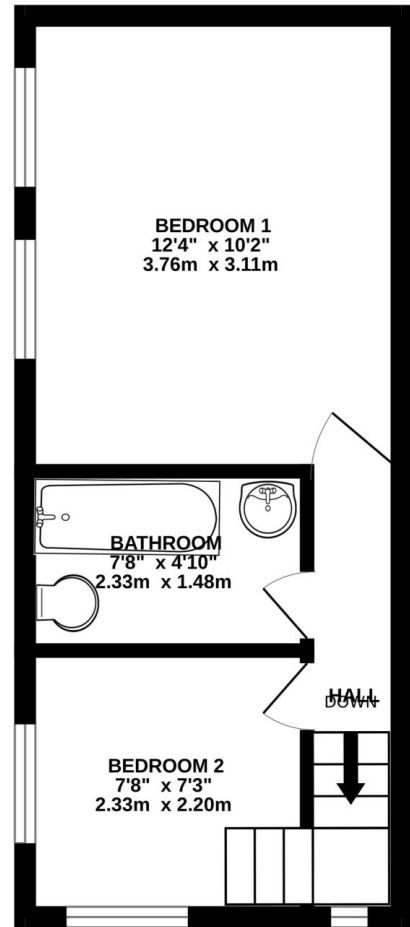

TOTAL FLOOR AREA : 498 sq.ft. (46.3 sq.m.) approx.

Whilst every attempt has been made to ensure the accuracy of the floorplan contained here, measurements of doors, windows, rooms and any other items are approximate and no responsibility is taken for any error, omission or mis-statement. This plan is for illustrative purposes only and should be used as such by any prospective purchaser. The services, systems and appliances shown have not been tested and no guarantee as to their operability or efficiency can be given.
Made with Metropix ©2023



PROPERTY DETAILS FOR

59a Derby Road, Douglas

Disclaimer

These particulars are for information purposes only and do not constitute or form any contract nor should any statement contained herein be relied upon as a representation of fact.

Neither the vendor nor Black Grace Cowley (the firm), nor any officer or employee of the firm accept liability or responsibility for any statement contained herein.

The vendor does not by these particulars, nor does the firm, nor does any officer or any employee of the firm have any authority to make or give any representation or warranty whatsoever as regards the property or otherwise. It is the sole responsibility of any person interested in the property described in these particulars to make all proper enquiries and searches to verify the description of the property and all other particulars herein.