



ASKING PRICE

£500,000



THE DETAILS



Plot, Glen Mona Loop Road

Maughold

£500,000

call in today or visit www.blackgracecowley.com for more details

e: hello@blackgracecowley.com | w: blackgracecowley.com | t: +44 (0) 1624 645555

a: 51 Victoria Street, DOUGLAS, Isle of Man, IM1 2LD

PROPERTY DETAILS FOR
Plot, Glen Mona Loop Road



e: hello@blackgracecowley.com | w: blackgracecowley.com | t: +44 (0) 1624 645555

a: 51 Victoria Street, DOUGLAS, Isle of Man, IM1 2LD

Plot, Glen Mona Loop Road





PROPERTY DETAILS FOR

Plot, Glen Mona Loop Road

THE DESCRIPTION

- Plot, Glen Mona Loop Road, Maughold
- Located in an area of high scenic value with exceptional views from the proposed property
- Approval in principle to erect a detached dwelling (Feb 2023)
- Field Numbers: 624255 & 624256
- Planning Applications: 22/01558/REM

e: hello@blackgracecowley.com | **w:** blackgracecowley.com | **t:** +44 (0) 1624 645555

a: 51 Victoria Street, DOUGLAS, Isle of Man, IM1 2LD

SITE PLAN



SITE PLAN

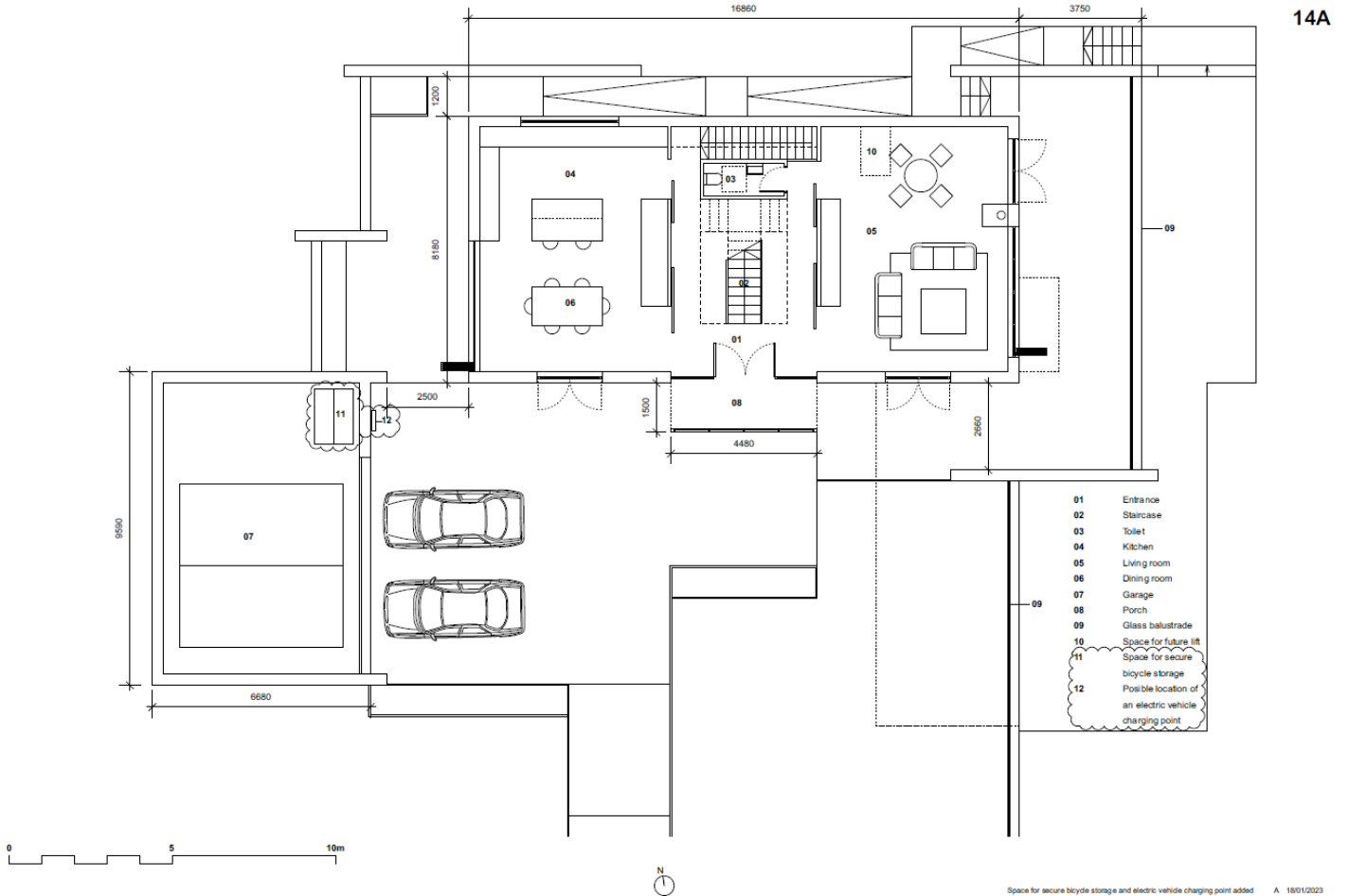

278_Field 624255 • Glen Mona • Alex Brindley

© **hormcastlethomas**
ARCHITECTS • DESIGNERS

Proposed ground floor plan 1.100 @ A3

SITE PLAN

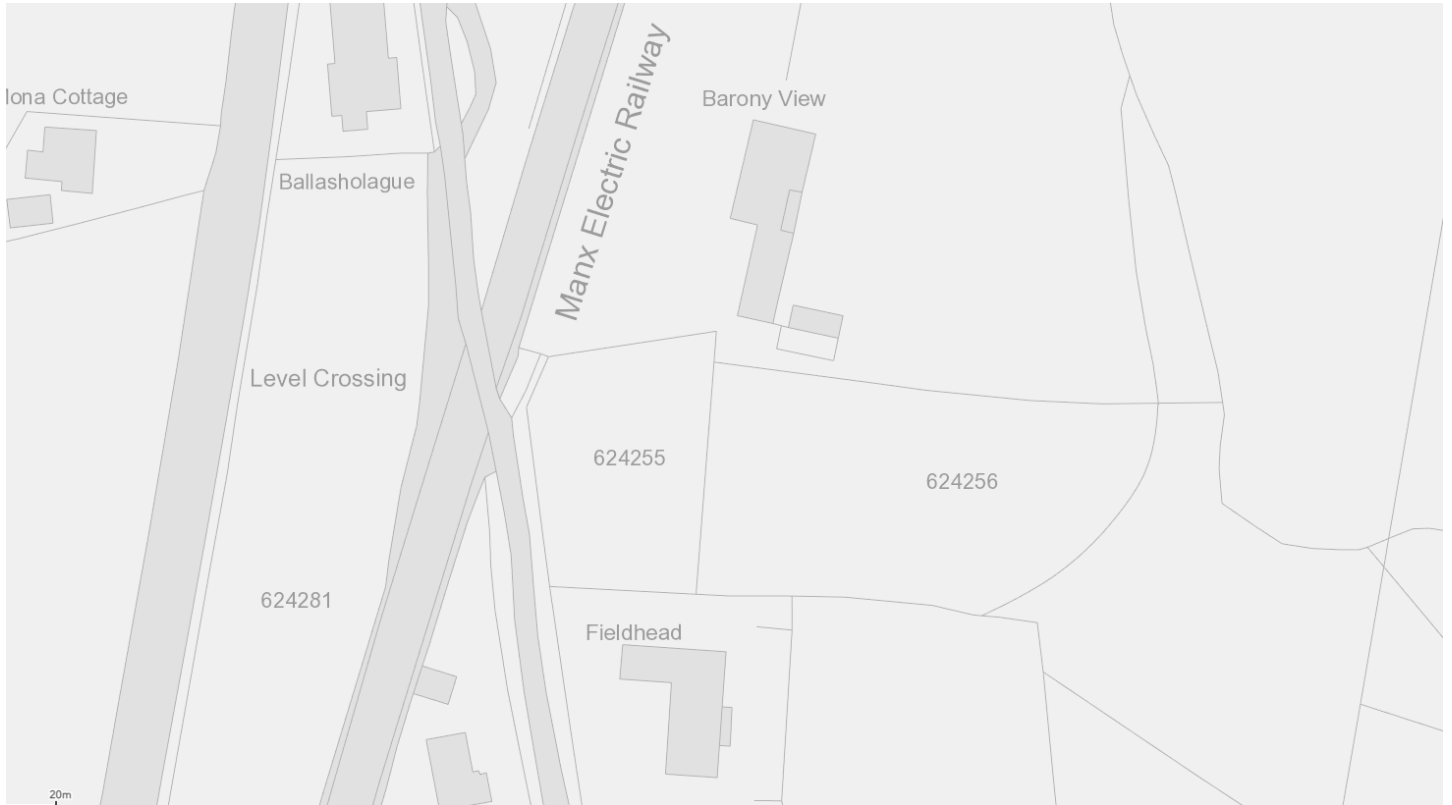



PROPERTY DETAILS FOR

Plot, Glen Mona Loop Road

Disclaimer

These particulars are for information purposes only and do not constitute or form any contract nor should any statement contained herein be relied upon as a representation of fact.

Neither the vendor nor Black Grace Cowley (the firm), nor any officer or employee of the firm accept liability or responsibility for any statement contained herein.

The vendor does not by these particulars, nor does the firm, nor does any officer or any employee of the firm have any authority to make or give any representation or warranty whatsoever as regards the property or otherwise. It is the sole responsibility of any person interested in the property described in these particulars to make all proper enquiries and searches to verify the description of the property and all other particulars herein.

e: hello@blackgracecowley.com | **w:** blackgracecowley.com | **t:** +44 (0) 1624 645555

a: 51 Victoria Street, DOUGLAS, Isle of Man, IM1 2LD