



ASKING PRICE

£150,000



THE DETAILS



4



4



4



The Crescent

Baldrine

£150,000

call in today or visit www.blackgracecowley.com for more details

e: hello@blackgracecowley.com | w: blackgracecowley.com | t: +44 (0) 1624 645555

a: 51 Victoria Street, DOUGLAS, Isle of Man, IM1 2LD



PROPERTY DETAILS FOR

Building Plot, The Crescent, Baldrine

THE DESCRIPTION

- Residential Development Opportunity
- A superb opportunity to acquire a unique development plot in an enviable location
- Detailed planning approval (in perpetuity) for a detached four-bedroom, four-bathroom new build house
- Elevated position with views over Clay Head towards Garwick Bay
- Viewing highly recommended
- All enquiries strictly via the sole Agent, Black Grace Cowley

THE PROPERTY

LOCATION

Travelling from Douglas into Baldrine, take the left hand turn onto the Crescent and continue up the private road for approximately 200m. The turning into the Plot is on the right-hand side, clearly identifiable by our For Sale Board.

e: hello@blackgracecowley.com | **w:** blackgracecowley.com | **t:** +44 (0) 1624 645555

a: 51 Victoria Street, DOUGLAS, Isle of Man, IM1 2LD

FLOORPLAN



SITE PLAN

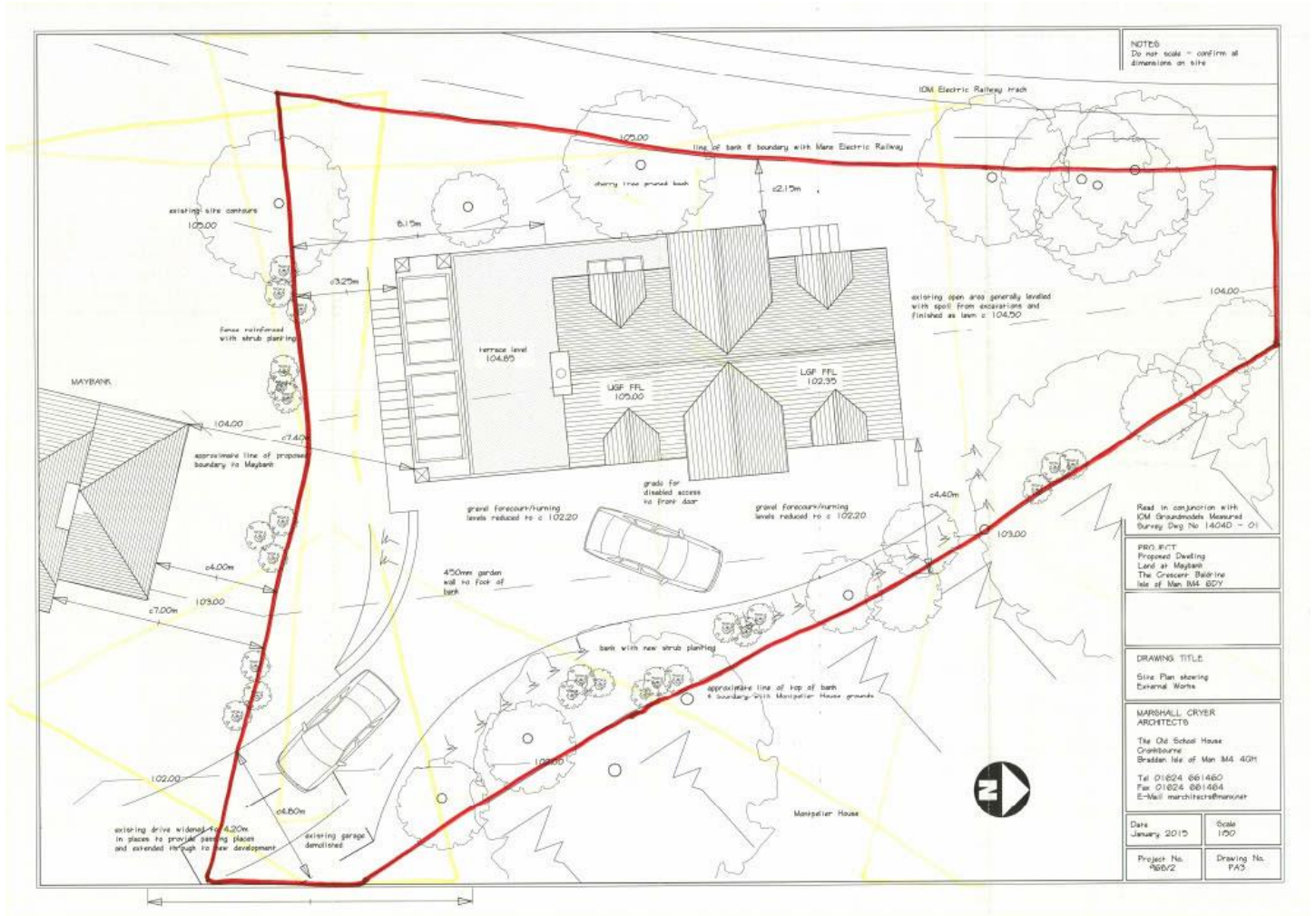

SITE PLAN

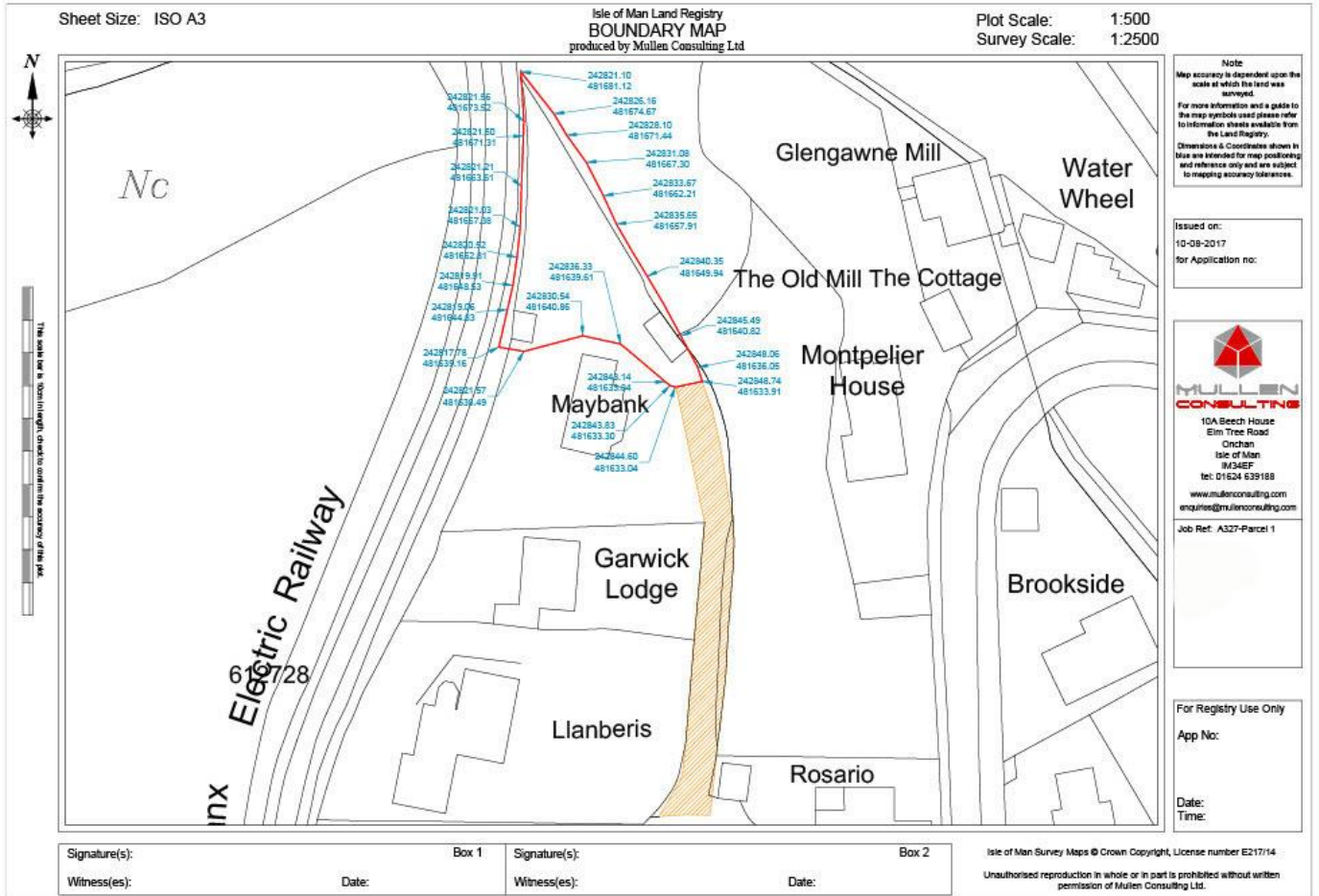



PROPERTY DETAILS FOR

Building Plot, The Crescent, Baldrine

Disclaimer

These particulars are for information purposes only and do not constitute or form any contract nor should any statement contained herein be relied upon as a representation of fact.

Neither the vendor nor Black Grace Cowley (the firm), nor any officer or employee of the firm accept liability or responsibility for any statement contained herein.

The vendor does not by these particulars, nor does the firm, nor does any officer or any employee of the firm have any authority to make or give any representation or warranty whatsoever as regards the property or otherwise. It is the sole responsibility of any person interested in the property described in these particulars to make all proper enquiries and searches to verify the description of the property and all other particulars herein.

e: hello@blackgracecowley.com | **w:** blackgracecowley.com | **t:** +44 (0) 1624 645555

a: 51 Victoria Street, DOUGLAS, Isle of Man, IM1 2LD