



ASKING PRICE

£204,950

## THE DETAILS



2



1



1



15 Woodview Court

Reayrt Ny Keylley, Peel

£204,950

call in today or visit [www.blackgracecowley.com](http://www.blackgracecowley.com) for more details

e: [peel@blackgracecowley.com](mailto:peel@blackgracecowley.com) | w: [blackgracecowley.com](http://blackgracecowley.com) | t: +44 (0) 1624 845 696

a: 9 Atholl Place, PEEL, Isle of Man, IM5 1HE









PROPERTY DETAILS FOR

## 15 Woodview Court, Reayrt Ny Keylley, Peel

### THE DESCRIPTION

- Well presented top floor apartment
- Situated in a sought after area
- Centrally located and only a short drive to Douglas and the South of the island
- Entrance Hall, Open Plan Kitchen/Diner/Lounge
- 2 double Bedrooms, Bathroom
- Two allocated parking spaces
- To be sold with the tenants in situ

### THE PROPERTY

Black Grace Cowley are pleased to offer 15 Woodview Court to the market, to be sold with the tenants in situ. A covered porch at the front of the building is home to the post boxes for each apartment with entry system. Through the wooden front door into the communal entrance hall with stairs to all floors. No.15 is situated on the second floor. Upon entering the apartment there is a hallway with storage cupboard. Accessed off the hall is the open-plan kitchen/diner/lounge with two uPVC double glazed windows enjoying views over the communal grounds. The kitchen is fitted with a range of base and wall units with contrasting worktops, built in oven and hob with extractor over and included in the sale is the fridge/freezer and washer/dryer. The apartment is complimented by two double bedrooms, and a modern bathroom fitted with a bath with shower over, wash hand basin and WC.

The property benefits from two allocated parking spaces. Gas fired central heating.

To be sold with tenants in situ (Lease expires April 2025).

Management Fees: £1050 per annum. 984 years remaining on Leasehold. Ground Rent: £241.82 per annum

**e:** [peel@blackgracecowley.com](mailto:peel@blackgracecowley.com) | **w:** [blackgracecowley.com](http://blackgracecowley.com) | **t:** +44 (0) 1624 845 696

**a:** 9 Atholl Place, PEEL, Isle of Man, IM5 1HE

## FLOORPLAN

GROUND FLOOR  
658 sq.ft. (61.1 sq.m.) approx.

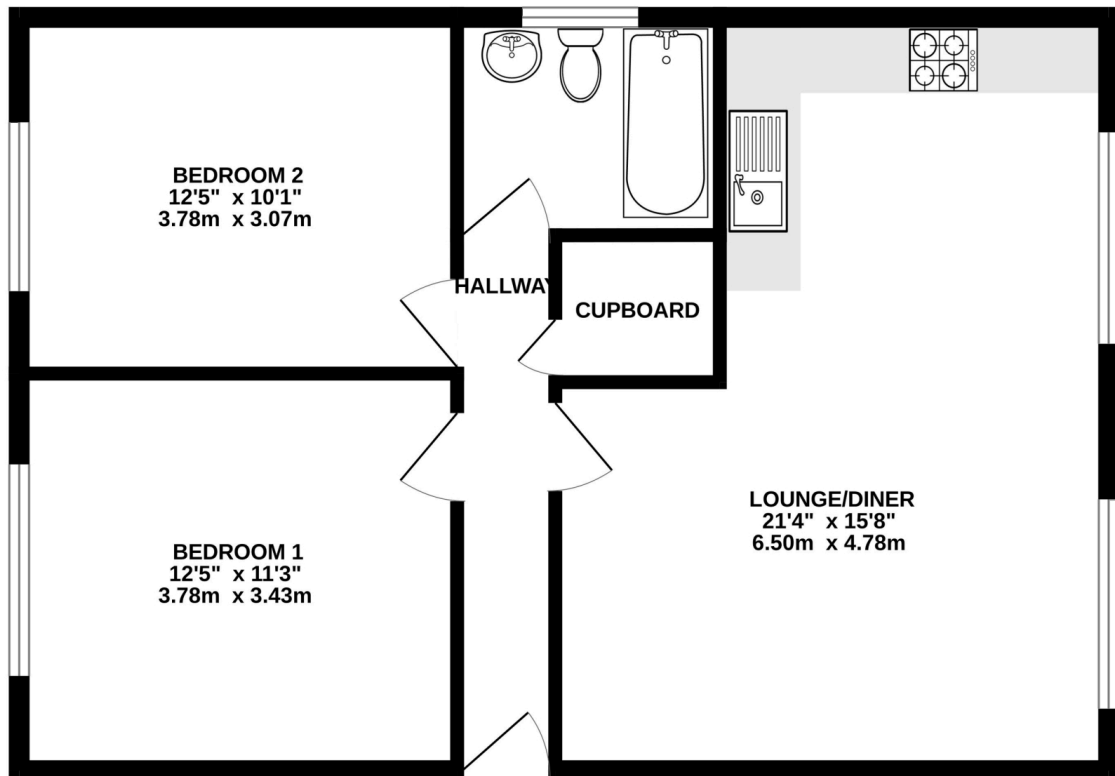

TOTAL FLOOR AREA : 658 sq.ft. (61.1 sq.m.) approx.

Whilst every attempt has been made to ensure the accuracy of the floorplan contained here, measurements of doors, windows, rooms and any other items are approximate and no responsibility is taken for any error, omission or mis-statement. This plan is for illustrative purposes only and should be used as such by any prospective purchaser. The services, systems and appliances shown have not been tested and no guarantee as to their operability or efficiency can be given.  
Made with Metropix ©2024



PROPERTY DETAILS FOR

# 15 Woodview Court, Reayrt Ny Keylley, Peel

## Disclaimer

These particulars are for information purposes only and do not constitute or form any contract nor should any statement contained herein be relied upon as a representation of fact.

Neither the vendor nor Black Grace Cowley (the firm), nor any officer or employee of the firm accept liability or responsibility for any statement contained herein.

The vendor does not by these particulars, nor does the firm, nor does any officer or any employee of the firm have any authority to make or give any representation or warranty whatsoever as regards the property or otherwise. It is the sole responsibility of any person interested in the property described in these particulars to make all proper enquiries and searches to verify the description of the property and all other particulars herein.

**e:** [peel@blackgracecowley.com](mailto:peel@blackgracecowley.com) | **w:** [blackgracecowley.com](http://blackgracecowley.com) | **t:** +44 (0) 1624 845 696

**a:** 9 Atholl Place, PEEL, Isle of Man, IM5 1HE